

MELBOURNE

abode

INSPIRATIONAL SPACES TO DWELL

Beachside 'resort' home

Melbourne builder Matt Hill creates his own

Home Planning

Create a room that fulfills your interior design dreams

Splashing Out

Whether you're into a few fast laps or an indulgent afternoon in the sun, there's a pool to suit every backyard.

Coastal Living

A guide to designer coastal living in Victoria

Home show

Check out the latest designs from some of Melbourne's premier home builders

Australia \$7.50
Annual Issue No. 5



www.abodemagazine.com.au

360+

INSPIRATIONAL HOME IDEAS



from Market Design

ELEVATED DESIGN

Denlin Construction Group's new contemporary style display home has been created for sloping blocks. This innovative design has been carefully fashioned to ensure a balance of practical function, appearance and value for money.

from the entry
A cosy formal lounge
the newly formal dining
and meals area
stove/appliance
reflects the
cathedral ceiling
outdoor entertain

The reserve

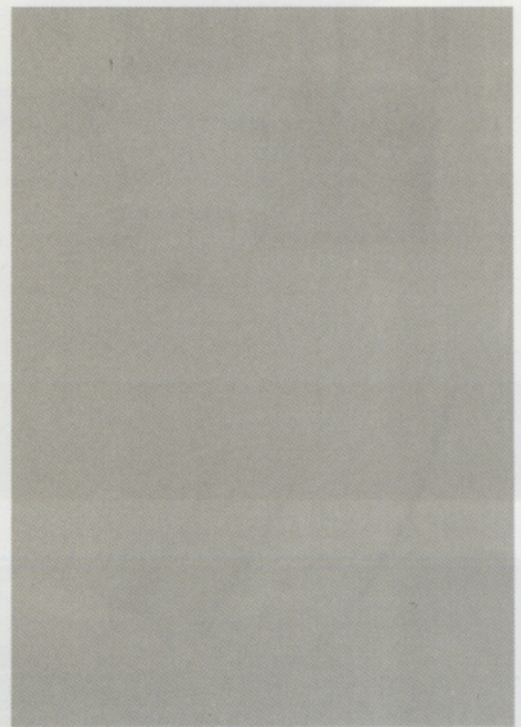
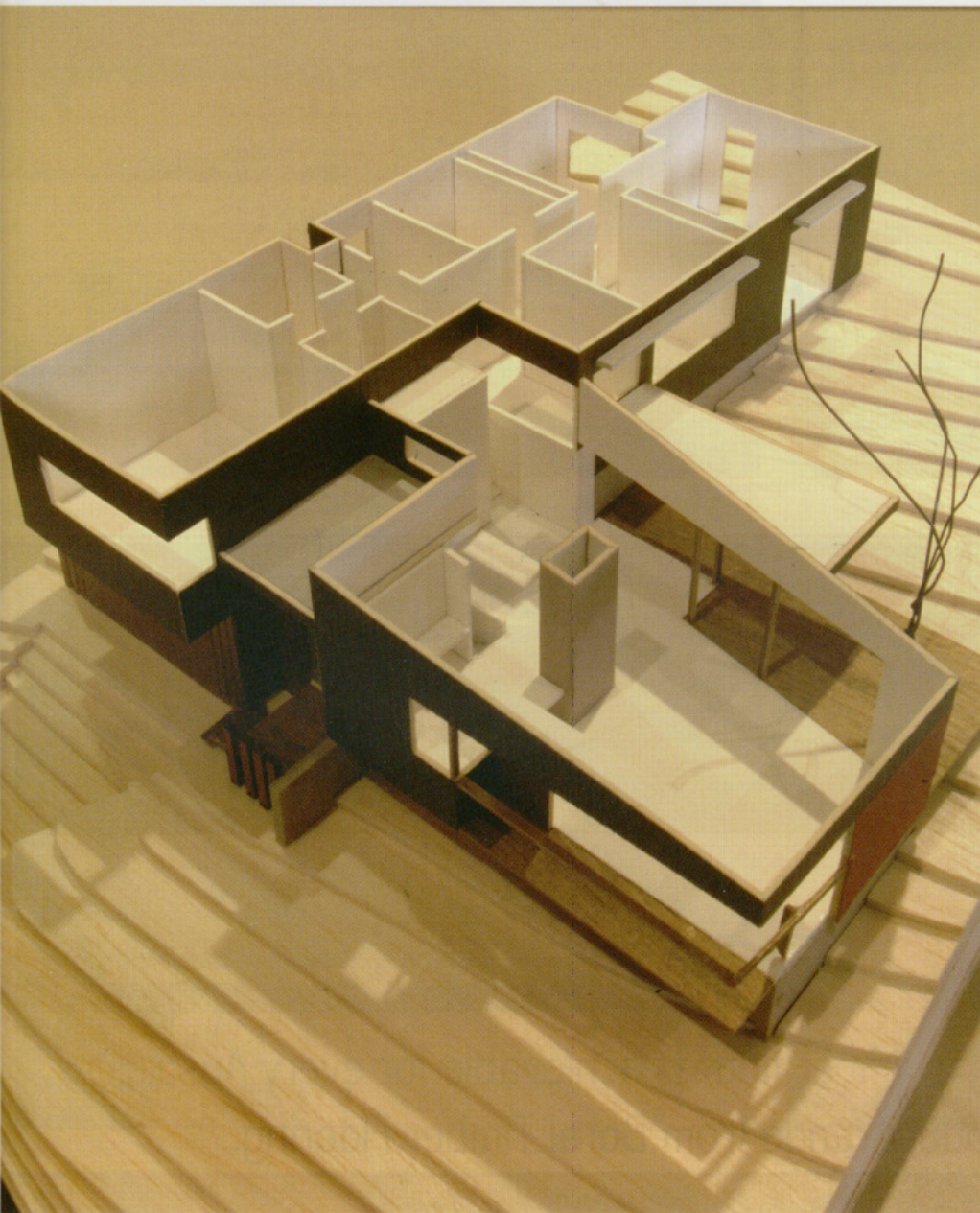

From its striking roof to its eco-friendly features, this attractive Sugarloaf Drive display home will complement the surrounding environment.

Denlin commissioned an award winning architect to create a unique home that showcases their multi award winning, consummate workmanship.

The property is one of a series of project homes located at Springthorpe Housing estate in Macleod, 10 kilometres north east of Melbourne. The location is attractive to those who desire to be relatively close to the city along with the space and tranquillity provided by the Australian bush.

Denlin Construction Group was asked by Springthorpe to make a new and innovative suburban prototype. The angled roof on the street side gives the Sugarloaf Drive property spirit whilst not being too alternative to alienate itself from the housing market. The roof design also allows the building to benefit from solar passive design, as does the house's placement on the sloping site.

The house sits elevated on the site and was built to utilise the expansive views of the surrounding neighbourhood and the

Dandenong Ranges.

Its L-shape design allows different sections to benefit for different reasons.

The street side uses large windows and its spectacular views. Northern sunlight pours natural light into its living and dining spaces. The arm that runs up the slope stands above the garage and street. It has the master bedroom backing onto the street, but allows for the rear children's rooms to have privacy, as they face the rear garden. The design uses a sense of openness to encourage interaction with family without comprising the need for privacy.

Denlin used a staged method to connect the areas. Occupants enter the house through a low platform, then step up to the living and dining areas by the middle platform, and can access the higher level by walking up the last platform past the study to the bedrooms. The gradual ascent created by the flowing connection between levels is a refreshing alternative to the traditional up and down method associated with double storey buildings.

The L-plan also frees up an unbelievable amount of backyard space for outdoor entertainment.

The home is adjacent to Gresswell Forest Wildlife Reserve. Designers have integrated the view of the flora and fauna into the design.

The dark timber façade of the house's exterior gives the property a bold and spectacular presence in the neighbourhood, and provides a stylish contrast against the lighter coloured masonry base that holds the structure in place.

The home is suitable for family living, as it is equipped with a variety of interesting spaces for work, play and being one with the bush.

The display is due to open to the public in late 2006, but the design is ready to be built onto any of the new release land at Springthorpe. For inquiries call Gerard Van Der Linden

Denlin Construction Group
229a Canterbury Rd,
Canterbury VIC 3126
T: (03) 9888 5544
email@denlingroup.com
www.denlingroup.com